

Package Contents

The kit contains a Main AP and a Client AP, which can be distinguished by the role switch on the AP.

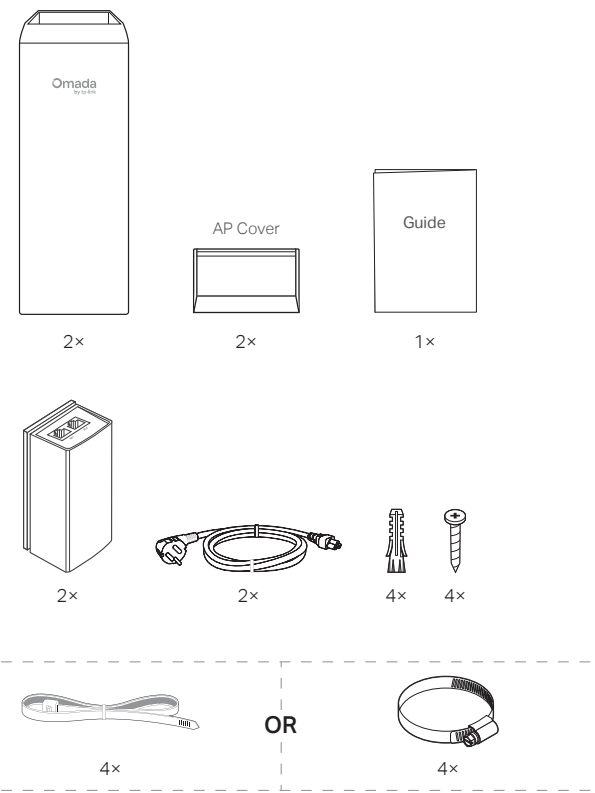

Note: Accessories may vary by region and model.

Grounding

Choose a grounding method according to site requirements:

Method ①: PoE Adapter + Shielded CAT5e (or above) Cable with Ground Wire + Grounded 3-Wire Power Outlet

Method ②: Grounding Terminal + Grounding Cable

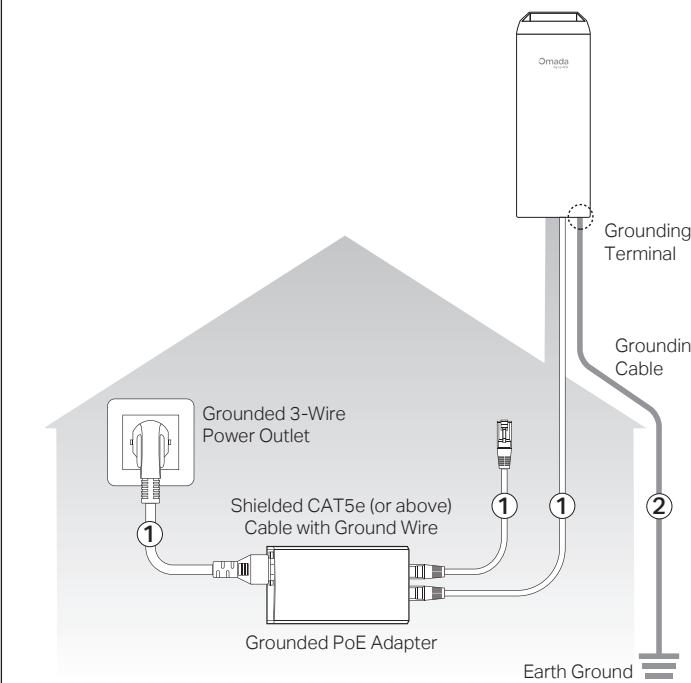

Power On

Option 1: Via Power Adapter

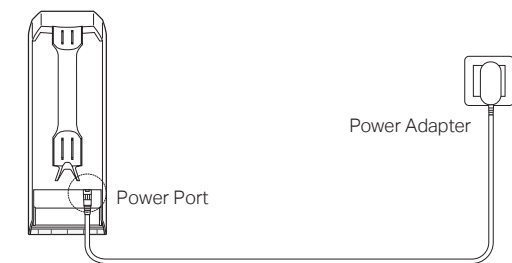

Option 3: Via Passive PoE Adapter

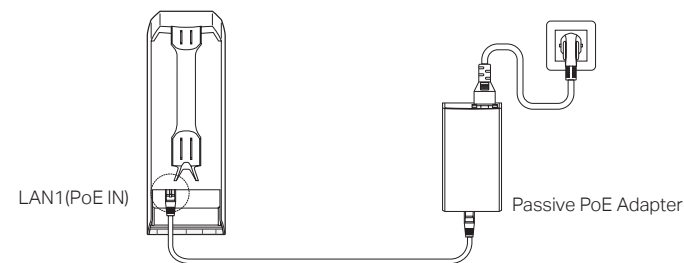

Option 2: Via PoE Switch

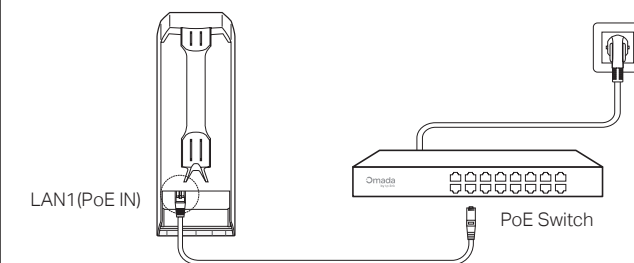

⚠ Slide the AP cover into place to seal and waterproof the AP after completing all connections.

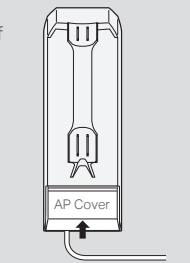

Pairing

Auto Pairing

The Main AP and Client AP in the same kit will automatically form a bridge network after powering on.

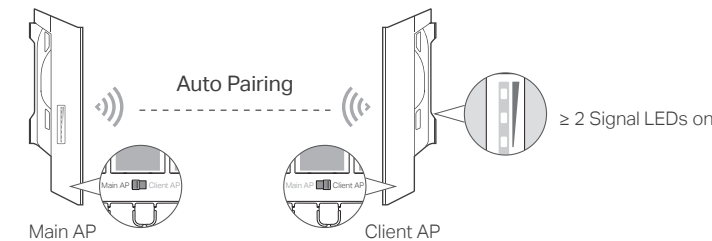

1. Check the role switch to ensure you connect the Main AP and Client AP in the network correctly. You can toggle the role switch to change the AP's role if needed.
2. The default SSID on the product is only for device access and management. If you need an SSID to access the internet and service networks, refer to the **Network Management** section to set up the AP.
3. In a network without a DHCP Server, the Main AP will use the DHCP fallback IP address 192.168.0.254 and assign IP addresses to Client APs.

PtMP Pairing

If needed, you can pair multiple Client APs with the Main AP to form a PtMP network.

① Ensure each new AP has not been set up and is switched to Client AP mode.

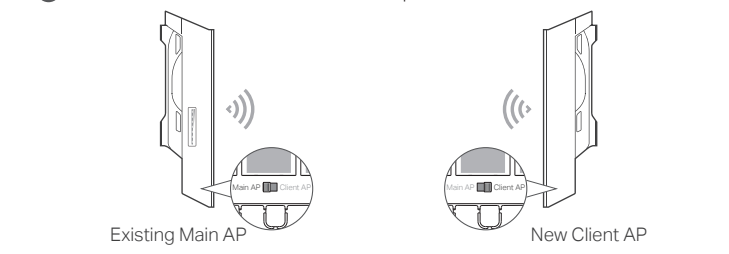

② Pair each new AP with the existing Main AP by using the Pair button.

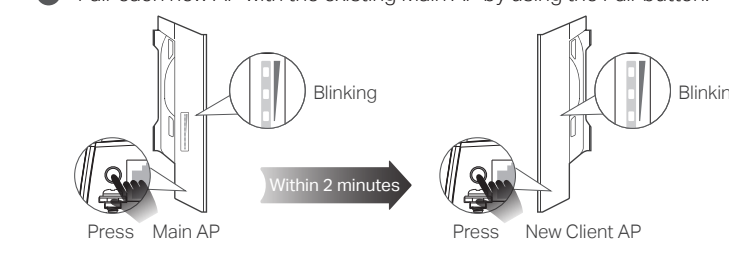

③ When the new AP's Signal LEDs turn solid, pairing is successful.

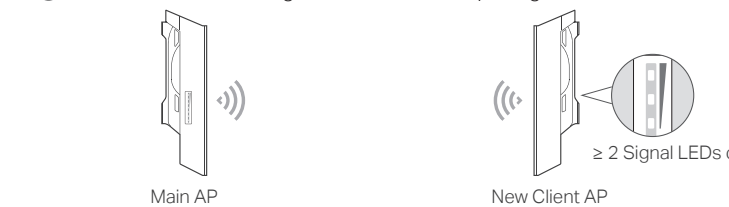

Typical Topology

Note: For EAP100-Bridge, it is recommended to use PtP instead of PtMP networking.

Scenario 1: Remote Camera Monitoring

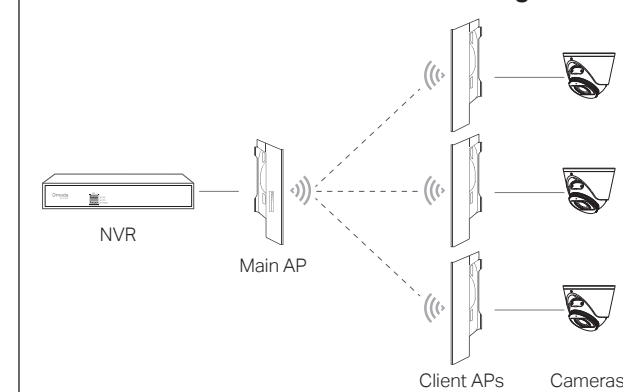

Scenario 2: Wi-Fi Extension

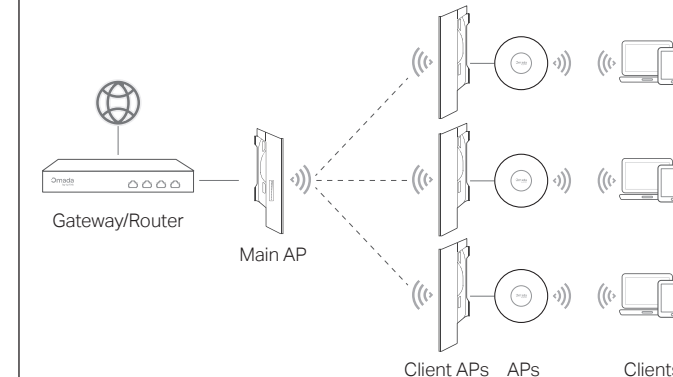

Mounting

Mount the AP

At the selected site, mount the AP and align the AP to the approximate direction that you have oriented.

Note: Mounting straps or hose clamps will be provided, depending on actual model.

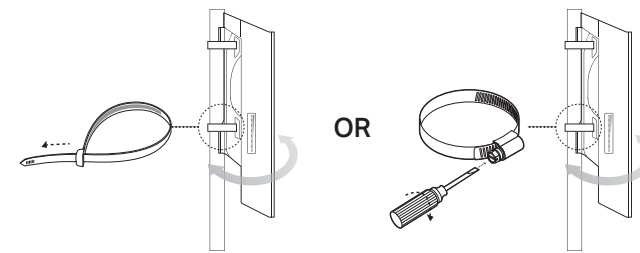

(Optional) Mount the Power Adapter

Note: This adapter shall be installed at a height of less than 2 meters.

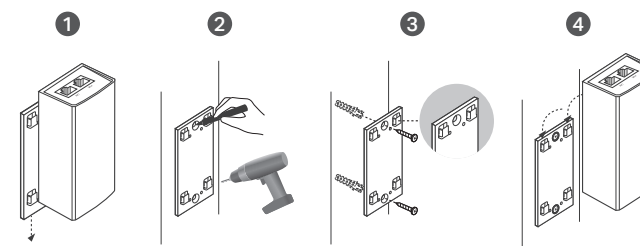

Network Management

Option 1: Standalone Mode

Configure and manage APs through the Main AP.

Default SSID:
Omada_XGHz_XXXXXX
(e.g., Omada_5GHz_1A2B3C)
Fallback IP If No DHCP Server:
192.168.0.254
Default Access:
<https://omadaeap.net>



Scan for Standalone Start Guide

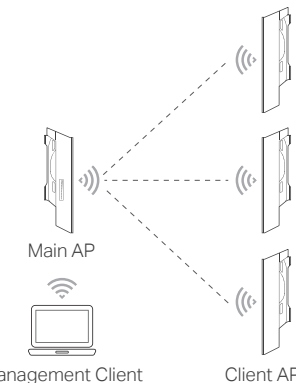

Option 2: Controller Mode

Configure and manage APs (and other Omada devices) centrally with an Omada Controller.

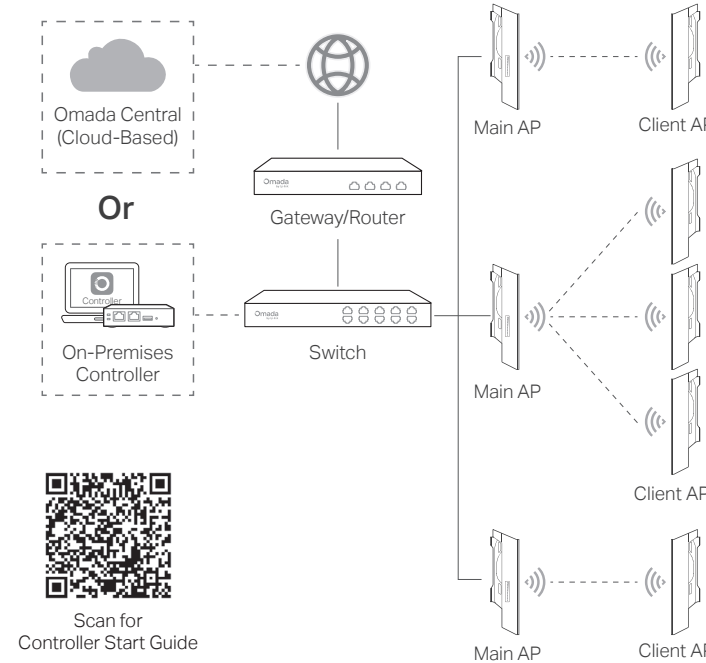

Scan for Controller Start Guide

Omada App

With the TP-Link Omada app, you can access and manage your Omada devices at a local site or remotely with a tap of your phone.



More Configurations

For more configurations, refer to the User Guides of the Omada Controller and Omada APs at: <https://support.omadanetworks.com/document/>



Safety Information

- Keep the device away from fire or hot environments. DO NOT immerse in water or any other liquid.
- Do not attempt to disassemble, repair, or modify the device. If you need service, please contact us.
- Do not use the device where wireless devices are not allowed.
- Do not use damaged charger or USB cable to charge the device.
- Do not use any other chargers than those recommended.
- The adapter shall be installed near the equipment and shall be easily accessible.
- The adapter should be used indoors where the ambient temperature is lower than or equal to 40 °C.
- The socket-outlet shall be installed near the equipment and shall be easily accessible.
- Plug the adapter into a wall outlet with an earthing connection through the power supply cord.
- Use only power supplies which are provided by manufacturer and in the original packing of this product. If you have any questions, please don't hesitate to contact us.
- Use only power supplies listed in the user instructions. Refer to the User Manual on the product support page.

TP-Link hereby declares that the Bridge AP is in compliance with the essential requirements and other relevant provisions of directives 2014/53/EU, 2009/125/EC, 2011/65/EU and (EU)2015/863. The original EU Declaration of Conformity may be found at <https://www.tp-link.com/en/support/ce/>.

TP-Link hereby declares that the Bridge AP is in compliance with the essential requirements and other relevant provisions of the Radio Equipment Regulations 2017. The original UK Declaration of Conformity may be found at <https://www.tp-link.com/support/ukca/>

For AP Controller, go to the **Devices** page and select the desired AP to specify the channel.

For web browser, go to **Wireless > Wireless Settings** to specify the channel.

For 5GHz models:

Attention: In EU member states, EFTA countries and Northern Ireland, the operation in the frequency range 5150MHz - 5350MHz is only permitted indoors.

Attention: In Great Britain, the operation in the frequency range 5150MHz - 5350MHz is only permitted indoors.

!	AT	BE	BG	CH	CY	CZ	DE	DK
	EE	EL	ES	FI	FR	HR	HU	IE
	IS	IT	LI	LT	LU	LV	MT	NL
	NO	PL	PT	RO	SE	SI	SK	UK(NI)



UK

More Resources

Main Site	https://www.omadanetworks.com/
Video Center	https://support.omadanetworks.com/video/
Documents	https://support.omadanetworks.com/document/
Product Support	https://support.omadanetworks.com/product/
Technical Support	https://support.omadanetworks.com/contact-support/

Warranty

For details on the warranty period, policy, and procedures, visit <https://support.omadanetworks.com/warranty-services/>.

Support

For technical support, user guides, and other information, please visit <https://support.omadanetworks.com/>, or simply scan the QR code.



Quick Installation Guide

Indoor/Outdoor Wireless Bridge



Scan for Bridge AP Start Guide

Note: EAP211-Bridge KIT is used for demonstration. Images may differ from your actual product.

© 2026 TP-Link 7100003141 REV3.2.2